

10 9 8 7 6 5 4 3 2 1

MAT'L NO.	ENG NO.	PLATING OPTION
15-24-4345	A-8981-4V5	TIN/LEAD
15-24-4745	A-8981-4V5-LF	TIN

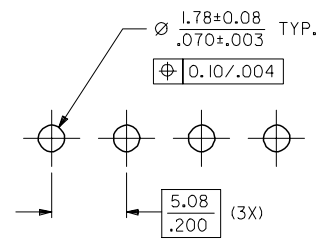
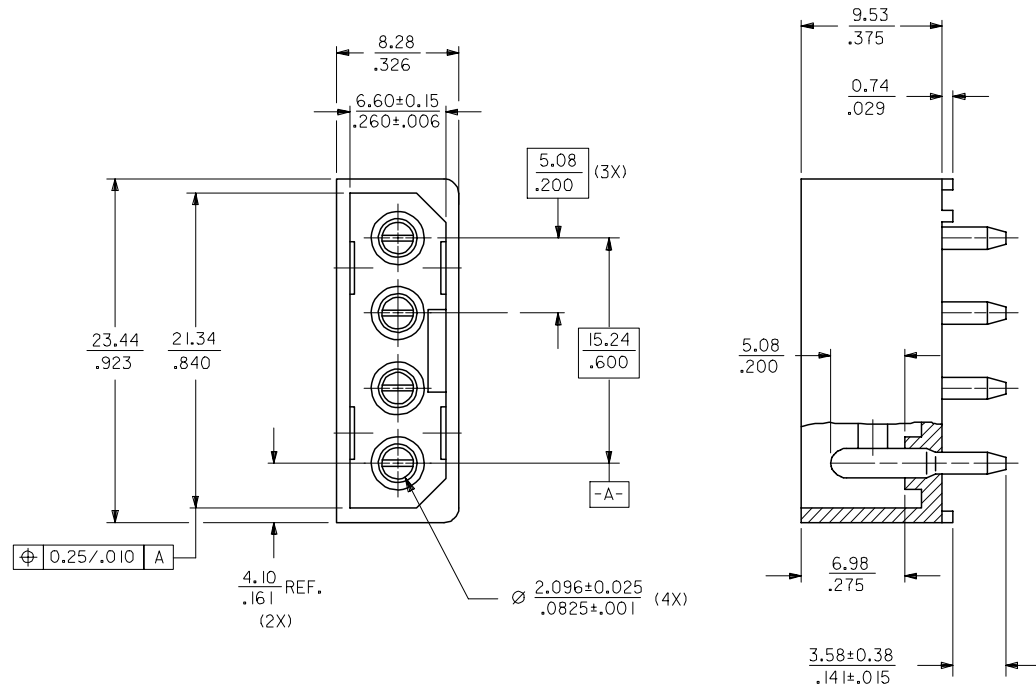

RECOMMENDED PCB HOLE LAYOUT

- NOTES :
1. PLATING
POSTPLATE 0.0025/4.000100 MIN. TIN/LEAD OR TIN OVER 0.00127/.000050 MIN. NICKEL OVERALL.
 2. PART TO MATE WITH 8981-4P*.
 3. PRODUCT SPEC PS-8981-4V4/4R1-P APPLIES.
 4. MATERIAL:
HOUSING - G.F. PCT UL94V-0
COLOR BLACK
TERMINAL - PHOS BRONZE

EDIT NOTE 3 EC NO: S2006-0765 DRWN: LO/IAO CHKD: BOKOK APPR: PTL/IM	2006/01/26 2006/01/26 2006/02/06	QUALITY SYMBOLS ▽=0 ◻=0	GENERAL TOLERANCES (UNLESS SPECIFIED)		DIMENSION STYLE		SCALE	DESIGN UNITS	THIRD ANGLE PROJECTION			
					MM/IN		NTS	METRIC				
			4 PLACES	± ---	± ---	DRAWN BY	DATE	TITLE POWER CONNECTOR, 4 CKTS VERTICAL MOUNT				
			3 PLACES	± ---	± .008	SKTOH	1991/10/17					
2 PLACES	± 0.20	± ---	CHECKED BY	DATE	MOLEX INCORPORATED							
1 PLACE	± ---	± ---	MLA1	1991/10/17								
			ANGULAR ± 3 °		APPROVED BY	DATE						
					RWONG	1991/10/18						
			DRAFT WHERE APPLICABLE MUST REMAIN WITHIN DIMENSIONS		MATERIAL NO.		DOCUMENT NO.		SHEET NO.			
					SEE TABLE		SD-8981-4V5		1 OF 1			
					THIS DRAWING CONTAINS INFORMATION THAT IS PROPRIETARY TO MOLEX INCORPORATED AND SHOULD NOT BE USED WITHOUT WRITTEN PERMISSION							

9 8 7 6 5 4 3 2 1